

ACE系列舞台电动葫芦

ACE STAGE ELECTRIC HOIST



型号/MODEL: ACE-1000 (2Br)

起升速度/LIFTING SPEED: 4M/MIN

起升重量/SAFE WORKING LOAD: 1000KG

📍 地址: 北京市海淀区金隅嘉华D座1005室

☎ 电话: +86 15313969865

🌐 网址: www.jdp.top

🏭 Manufacturer: JDP China Drive Systems Co., Ltd

☎ TEL: +86 15313969865

🌐 Website: www.jdp.top

✉ Email: admin@jdp.top

CONTENTS 目录

1.产品简介	3
2.技术数据	4
2.1.标准配置	4
2.2.选装配置	4
2.3.线形图	5
2.3.产品爆炸图	7
3.电器数据	8

1.PRODUCT INTRODUCTION	3
2.TECHNICAL DATA	4
2.1.STANDARD VERSION	4
2.2.OPTIONAL CONFIGURATION	4
2.3.LINE GRAPH	5
2.3.PRODUCTS EXPLOSION VIEW	7
3.ELECTRICAL DATA	8



产品简介

水平对置双刹车系统

两个电磁刹车安装在整机的中心线上，在运行时完全独立工作，响应迅速且更为平稳，增加了制动的安全性。

Two electro-magnetic brakes are mounted on the center line of the machine body. They work independently with quick and steady response, increasing the safety of braking performance.

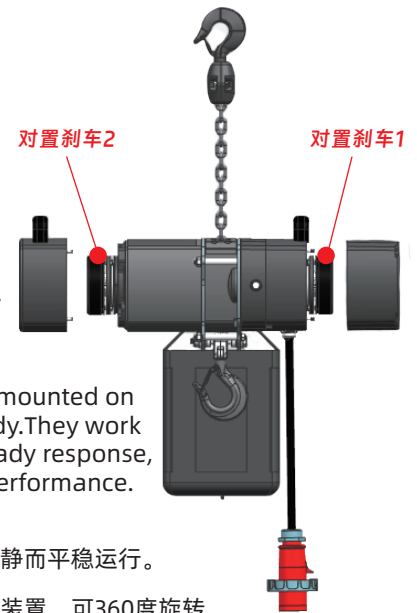

- 全新的侧出链设计可以保证链条安静而平稳运行。
- 吊钩采用合金钢锻造，设有防脱钩装置，可360度旋转。
- 内置式机械超载安全离合器防止超载或是冲顶对葫芦本体及链条带来的损害。
- 起重链轮由特种合金钢制造，五链窝设计采用双侧轴承，运行平稳安静。
- 齿轮箱采用高强度铝合金压铸一体成型，轻巧坚固、强度更高、耐腐蚀性能好。
- 电机采用铝合金拉伸外壳，独有散热功能适应高频率作业，防护等级IP65。
- 电磁刹车精简设计，不会出现刹车线圈故障，也不需更换刹车盘。

Product Introduction

- Innovative chains side-guiding-out design for quiet and steady operation.
- 360° swivel hooks made of forged alloy steel. Anti-detaching device is equipped.
- Built-in mechanical overload protection clutch to avoid collision and overload damage.
- Lifting sprocket is made of special alloy with 5 pockets and double sides bearing. Steady and quiet operation.
- The gearbox is formed by die-casting high-strength aluminum alloy, light and strong with higher strength and better corrosion resistance.
- Motor with an aluminum alloy tensile shell, unique heat dissipation function, suitable for high-frequency operation, and its protection level is IP65.
- Simple electromagnetic brake design, no failure of the brake coil, and no need to replace the brake disc.

标准配置:

- 设备型号: ACE-1000 (2Br)
 - 起重量: 1000 Kg
 - 提升速度 (m/min): 4
 - 直接控制: 220-440V、3ph、50/60Hz (见图4,P8)
 - 供电电缆: 1m电源线, 带CEE-16A/4芯
 - 链条尺寸 EN818-7 (mm): 7.1*21
 - 链条重量 (Kg/m): 1.1
 - 链条等级: G100
 - 链条表面: 镀锌 (蓝白)
 - 导链器: 带有5个链窝链轮的精密导链器
 - 链条行数: 1
 - 链条袋: 1纺织链条袋, 可拆卸, ≤30米
 - 满载噪音 (dB): ≤65
 - 制动器: 2个直流制动
 - 吊钩: 1个下 (可旋转)
 - 悬挂方式: 吊钩悬挂
 - 安装方式: 自爬或固定
 - 塑料手柄: 无
 - 防护等级: IP65
 - 不含链条的重量 (kg): 44
 - 电机功率 (KW): 1.5
 - 电流消耗 (A): 3.7
 - 机械等级/FEM9.511: 1Bm/25%ED
 - 颜色: 黑色, 色号RAL 9005 哑光
 - 离合器: 获得专利的摩擦离合器, 用于过载保护
-

STANDARD VERSION:

- Model : ACE-1000 (2Br)
 - SWL acc.: 1000 Kg
 - Lifting speed (m/min) : 4
 - High voltage directly control :
220-440V、3ph、50/60Hz (See Figure4,P8)
 - Power supply cable : 1m power supply cable, CEE-16A/4 cord
 - Chain acc. EN818-7 (mm) : 7.1*21
 - Chain net weight (Kg/m) : 1.1
 - Grade of chain : G100
 - Chain surface : Galvanized (bluish white)
 - Chain Guide : Precise chain guide with 5-pocket chain wheel
 - Chain falls : 1
 - Chain bag : 1 textile chain bag, detachable, ≤30 meters
 - Full load noise level (db) : ≤65
 - Brake: 2 DC brake
 - Load hook: 1-fall / turnable
 - Suspension: Hook suspension
 - Mounting position: Climbing & stationary
 - Plastic handles: None
 - Protection level: IP65
 - Weight without chain (kg): 44
 - Motor power (KW) : ca.1.5
 - Current consumption (A): ca.3.7
 - Mechanism class /FEM9.511: 1Bm/ 25% ED
 - Color:black, RAL 9005 matt
 - Clutch : Patented friction clutch for overload protection
-

电动葫芦尺寸表/ELECTRIC CHAIN HOIST SIZE

图1/Figure 1

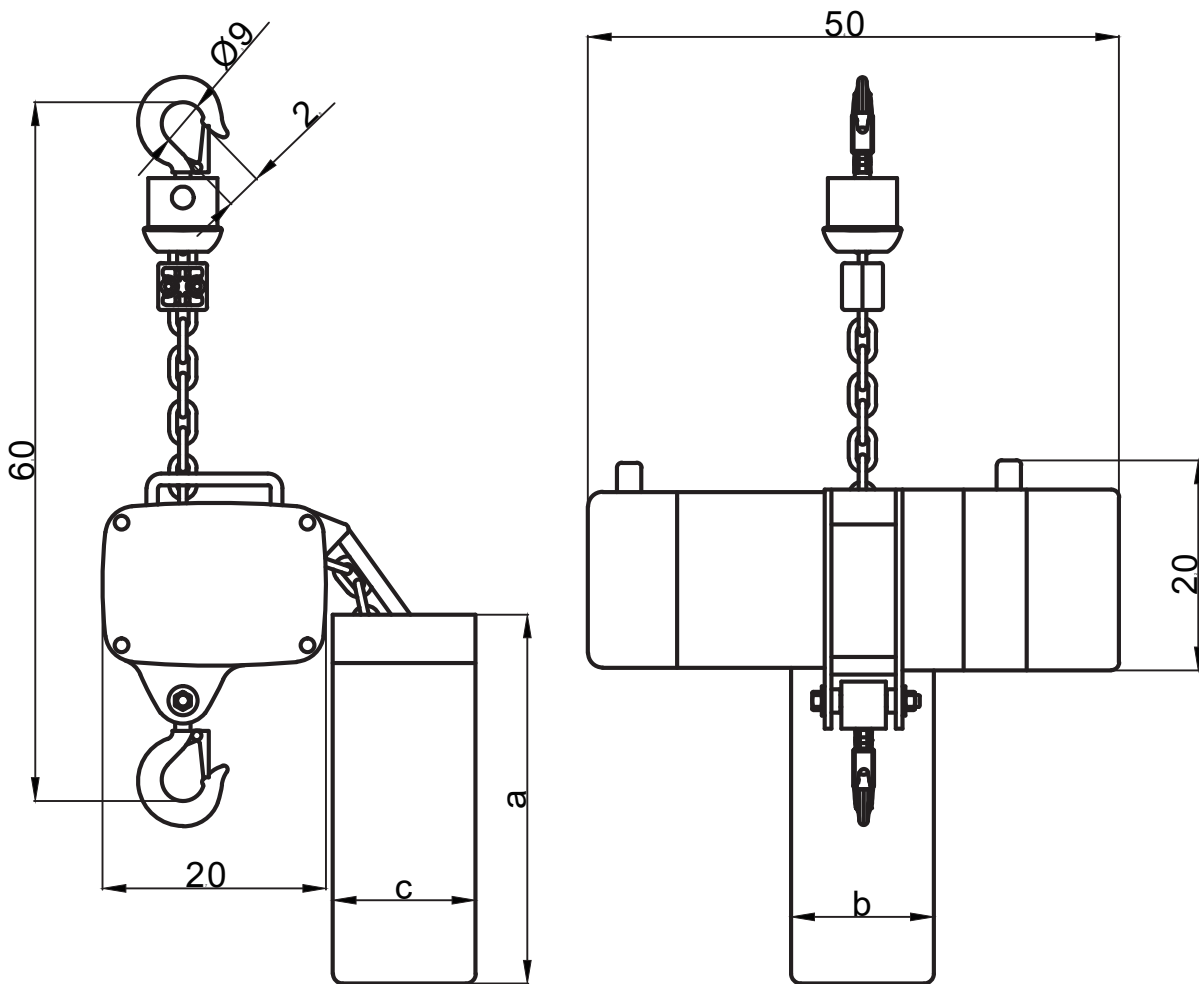

链条袋规格/CHAIN BAG SPECIFICATION			
链条长度 CHAIN LENGTH(m)	链条袋尺寸/CHAIN BAG SIZE(mm)		
	a	b	c
10	200	250	180
20	250	250	180
30	350	250	180

注：单位mm/Note:Unit mm

吊钩组件/HOOK ASSEMBLY

上钩组件/Component of the upper hook

图2/Figure 2

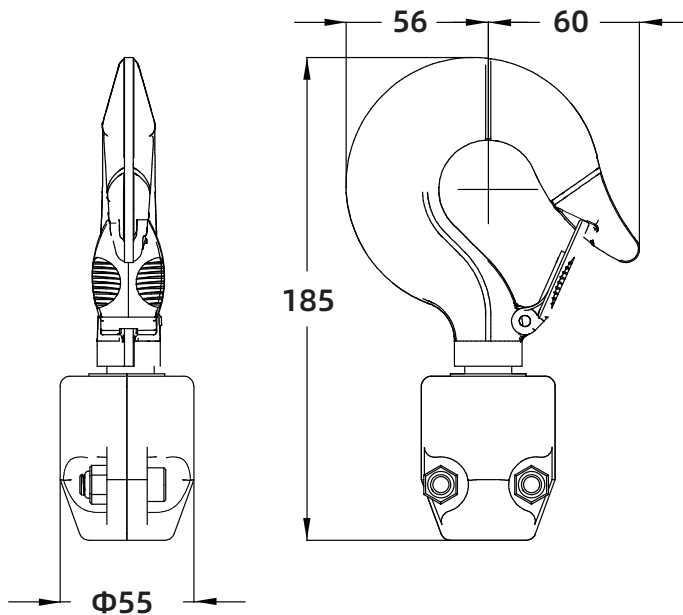

吊钩规格型号 HOOK SPECIFICATION	a1	b1	b2	d	h1	h2	B1	B2
HG-D-1T	33	7	7	40	37	35	21	21

Detail diagram of the hook's throat showing dimensions: a1 (throat width), b1 (throat thickness), b2 (throat thickness), d (throat diameter), h1 (throat height), and h2 (throat height).

下钩组件/Lower hook assembly

图3/Figure 3

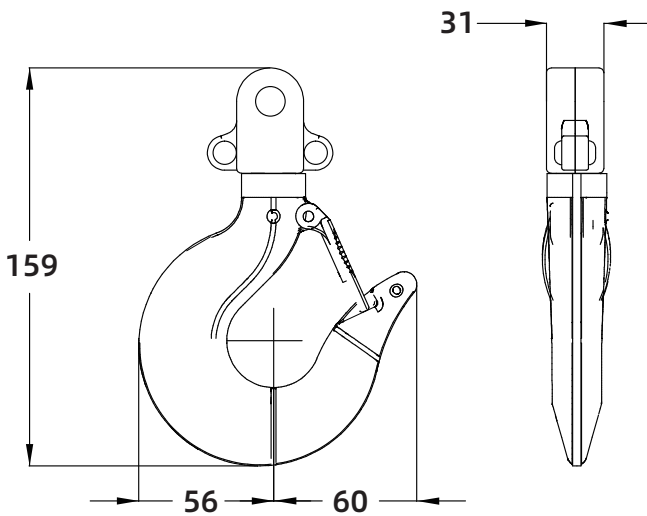

吊钩规格型号 HOOK SPECIFICATION	a1	b1	b2	d	h1	h2	B1	B2
HG-D-1T	33	7	7	40	37	35	21	21

Detail diagram of the hook's throat showing dimensions: a1 (throat width), b1 (throat thickness), b2 (throat thickness), d (throat diameter), h1 (throat height), and h2 (throat height).

注：单位mm/Note:Unit mm

产品结构表/PRODUCT STRUCTURE

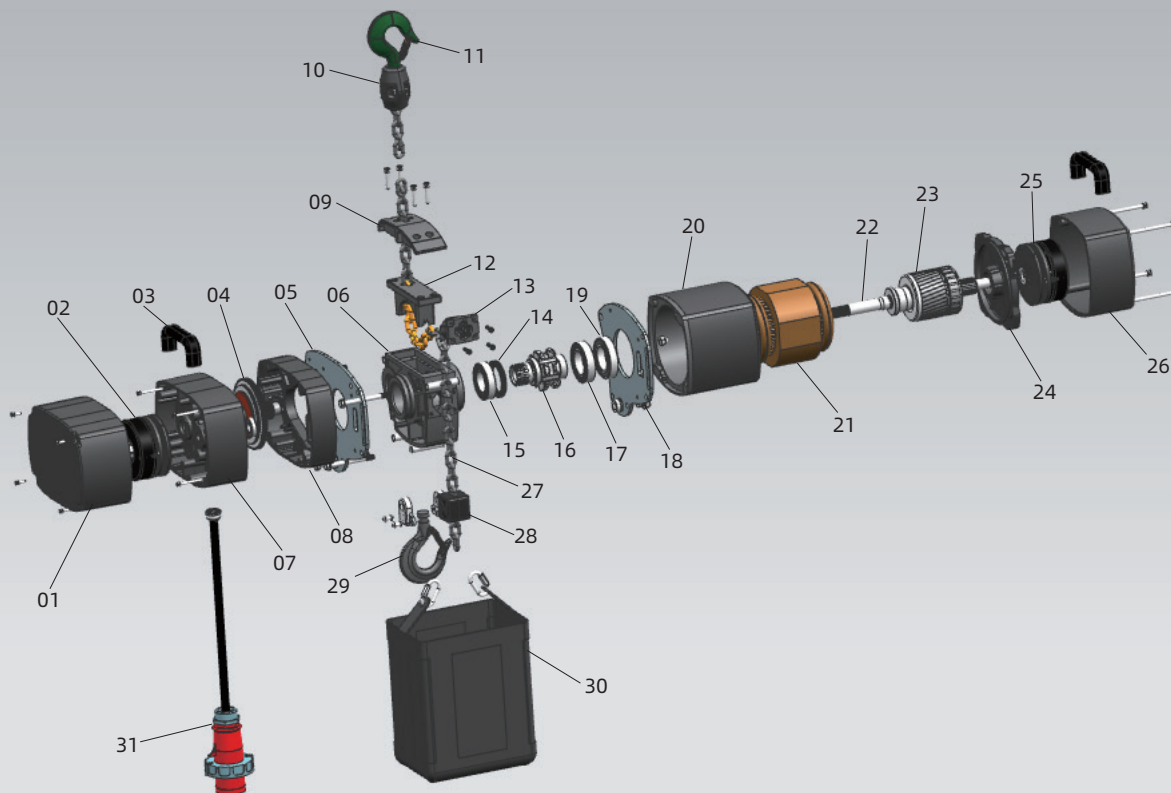

01: 电器盖	02: 电磁刹车	03: 提手	04: 离合器	05: 葫芦板	06: 中间件
07: 齿轮箱盖	08: 齿轮箱	09: 盖板	10: 下钩夹板	11: 起重钩	12: 导链架
13: 侧出链器	14: 轴承固定圈	15: 轴承	16: 起重链轮	17: 轴承	18: 葫芦板
19: 轴承	20: 电机箱	21: 电机定子	22: 输出轴	23: 转子	24: 刹车刷
25: 电磁刹车	26: 电机箱盖	27: 链条	28: 限位锁块	29: 葫芦钩	30: 储链袋
31: 航空插头					
01: electrical cover	02: electro-magnetic brake	03: handle	04: clutch	05: plate of hoist	06: middleware
07: cover of gear box	08: gear box	09: cover plate	10: under hook splint	11: hook of hoist	12: chain guide bracket
13: side chain organizer	14: bearing retaining ring	15: bearing	16: lifting sprocket	17: bearing	18: plate of hoist
19: bearing	20: motor box	21: motor stator	22: output shaft	23: rotor	24: brake cut
25: electro-magnetic brake	26: motor box cover	27: chain	28: limit block	29: hook of hoist	30: Chain bag
31: aviation plug					

电器线路图/Electrical wiring diagram

高压直控-3Ph+PE/High voltage directly control-3Ph+PE

图4/ Figure 4

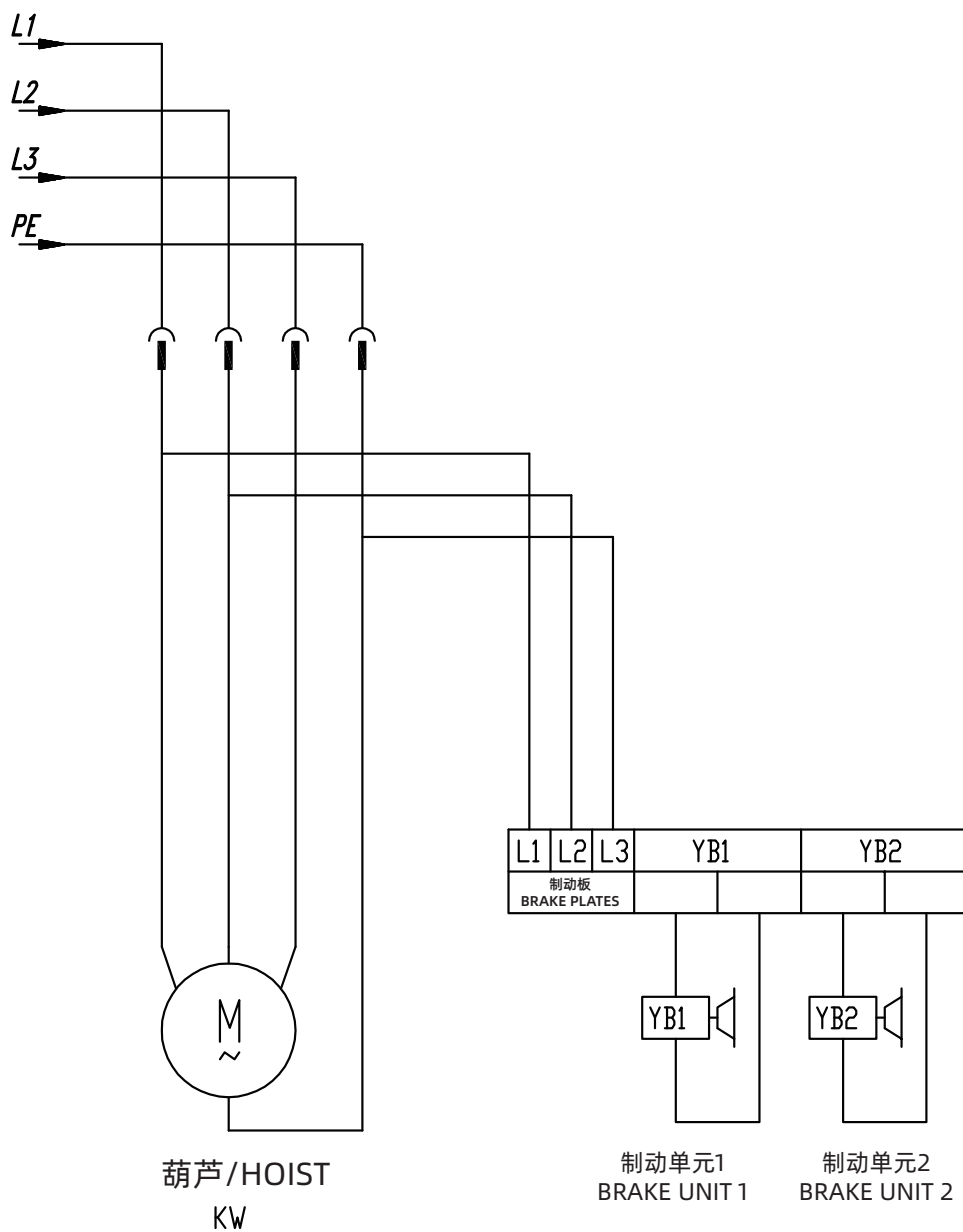

注：不带限位/Note: without limit switch